

mellerware®

E X E C U T I V E

V e l o c i t y | 18" S t a n d F a n

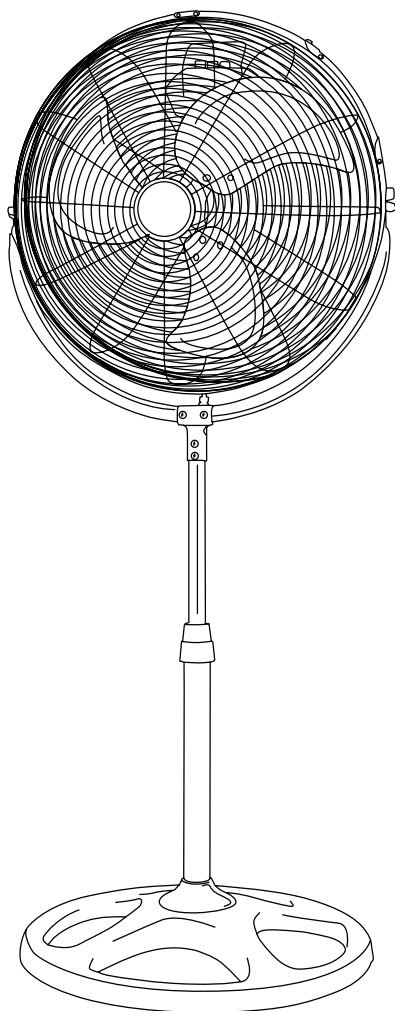

complies with
INTERNATIONAL
IEC60355
SAFETY SPECIFICATIONS



CE
2 YEAR
GUARANTEE

Model:
35900

PLEASE READ ALL INSTRUCTIONS BEFORE USE

2 year guarantee

KEYS AND CHARACTERISTICS:

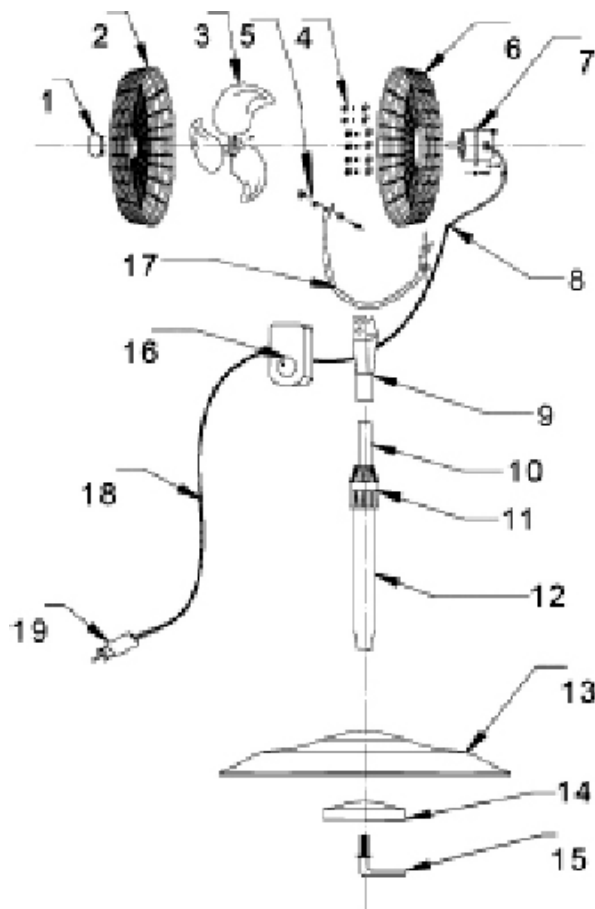

Description

1. Grill Deco
2. Front Grille
3. Blade
4. Screw
5. Screw
6. Rear grille
7. Motor
8. Power cord
9. Pipe
10. Standing pipe
11. Stand lock
12. Standing pipe
13. Round base
14. Bearing piece
15. Screw
16. Knob switch
17. "U" pipe
18. Power cord

READ AND SAVE THESE INSTRUCTIONS

Electrical connections shall be in accordance with national or local codes, before inserting the power plug into an electrical outlet, check if the voltage frequency on the rating label are in agreement with local voltage!

Safety Instructions

1. Read all instructions.
2. Disconnect the power plug before dismantling, assembling or before cleaning.
3. Avoid touching mobile parts of the fan.
4. Ensure that fan is on a dry and even surface.
5. Never insert fingers, pencils or any other objects though the guards whenever the power plug is connected, especially while running.
6. The appliance is not intended for use by young children or disabled persons without supervision.
7. Do not use the appliance for any other purpose than its intended use.
8. The fan must not be used if the guards are not fasted according to instructions.
9. If the power cord is damaged, or any other part of the appliance, it must be replaced by an authorized repair agent. Do not carry out repairs by anyone other than an authorized repair agent as this could be dangerous and will void the guarantee.
10. Do not use your appliance with an extension cord unless it has been checked and tested by a qualified electrician or electrical supplier.

Operating Instructions

1. Insert the plug into the wall outlet.
2. Switch Control: To turn on the fan, simply push any of the speed control buttons: 3=High speed; 2=Middle Speed; in order to turn it off, push the "O" button.
3. Tilting Adjustment: Always switch the fan off before making a tilt adjustment.
The air flow can be adjusted upward or downward by moving the guard up or down.
4. Height Adjustment: Loosen the height

adjustment ring, then adjust the pipe to desired height and then retighten it.

Maintenance Guideline

1. Use the fan in a dry place, free of excessive humidity and water.
2. Keep the fan clean. Wipe away dirt with a clean cloth.
3. Do not use spirits or thinners to clean fan.
4. Before putting the fan in storage, clean it thoroughly, then cover with a plastic bag and store in a dry place.

Warning:

1. Do not touch the blades with your hand or hard object before the fan comes to a standstill.
2. Do not pull the power cord to unplug the appliance from the wall.
3. Before cleaning the appliance disconnect it from the power, take off the front guard and blade. Use a soft cloth to clean oil stains. Please do not bump the blade or change its shape.

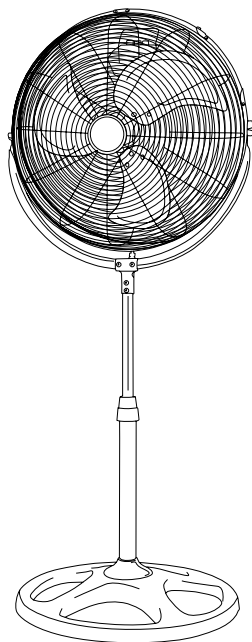

creative housewares

27 Nourse Avenue Epping 2 Cape Town
P.O. Box 975 Eppindust 7475 South Africa
Tel: +27 21 534 8114 Fax: +27 21 534 8086
Service Centre Share Call: 086 111 5006
web: www.creativehousewares.co.za